

Adjustable Stainless Steel-Tension levers

SPECIFICATION

Type

- Type **E**: angled lever
 Stainless Steel AISI 303
 Hub and shaft matt shot-blasted
 Ball knobs DIN 319 (see page 538)
 Plastic, Duroplast
 black, shiny finish

INFORMATION

Adjustable tension levers GN 212.5 have proved to be ideal whenever parts have to be clamped in a confined space or a particular lever position is required. The threaded insert is connected with the hub via serrations which can be disengaged. Pulling the lever, disengages the serrations and allowing it to be swivelled to the ideal clamping position. On releasing the lever it will automatically re-engage.

ON REQUEST

- straight lever (90°)

TECHNICAL INFORMATION

- Stainless Steel characteristics (see page A26)

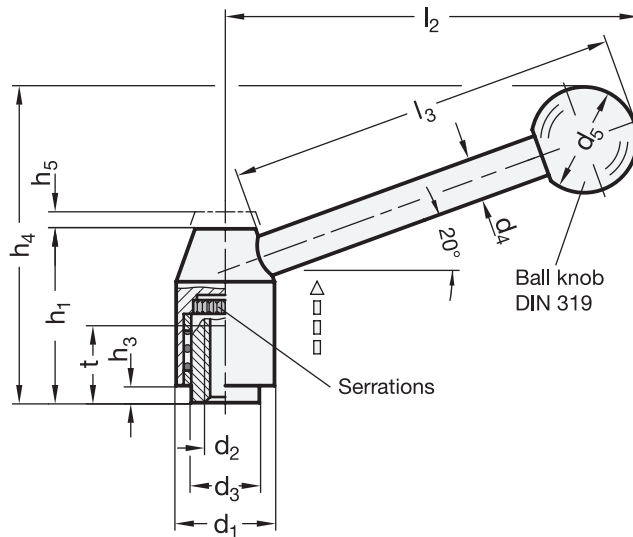

GN 212.5-with threaded insert

STAINLESS STEEL

| Description | d1 | d2 | d3 | d4 | d5 | h1 | h3 | h4 | h5 | l2 | l3 ≈ | t min. | △ |
|-------------------|----|------|------|----|----|------|-----|----|-----|-----|------|--------|-----|
| GN 212.5-21-M6-E | 21 | M 6 | 13.5 | 8 | 20 | 33.5 | 1 | 59 | 4 | 75 | 70 | 11 | 97 |
| GN 212.5-21-M8-E | 21 | M 8 | 13.5 | 8 | 20 | 33.5 | 1 | 59 | 4 | 75 | 70 | 11 | 93 |
| GN 212.5-24-M8-E | 24 | M 8 | 16 | 10 | 25 | 40 | 2.5 | 75 | 4.5 | 101 | 96 | 14 | 170 |
| GN 212.5-24-M10-E | 24 | M 10 | 16 | 10 | 25 | 40 | 2.5 | 75 | 4.5 | 101 | 96 | 14 | 161 |
| GN 212.5-28-M10-E | 28 | M 10 | 19 | 12 | 30 | 48.5 | 4.5 | 89 | 4.5 | 116 | 110 | 17 | 261 |
| GN 212.5-28-M12-E | 28 | M 12 | 19 | 12 | 30 | 48.5 | 4.5 | 89 | 4.5 | 116 | 110 | 17 | 258 |



Clamping levers 3

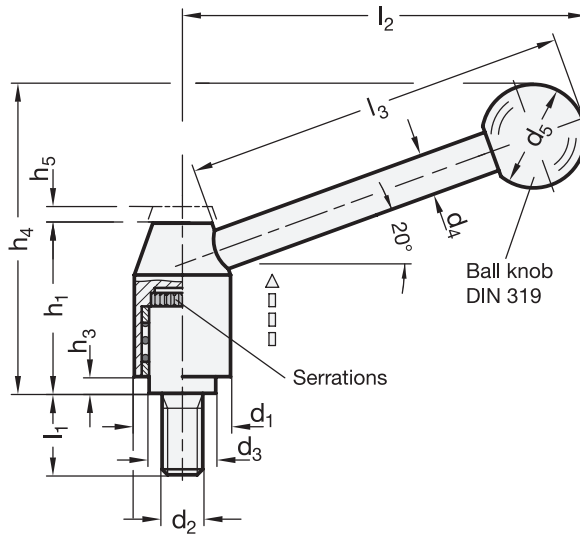

GN 212.5-with threaded stud

STAINLESS STEEL

| Description | d1 | d2 | l1 | d3 | d4 | d5 | h1 | h3 | h4 | h5 | l2 | l3 ≈ | Δ |
|----------------------|----|------|----|------|----|----|------|-----|----|-----|-----|------|-----|
| GN 212.5-21-M8-16-E | 21 | M 8 | 16 | 13.5 | 8 | 20 | 33.5 | 1 | 59 | 4 | 75 | 70 | 104 |
| GN 212.5-21-M8-20-E | 21 | M 8 | 20 | 13.5 | 8 | 20 | 33.5 | 1 | 59 | 4 | 75 | 70 | 105 |
| GN 212.5-21-M8-25-E | 21 | M 8 | 25 | 13.5 | 8 | 20 | 33.5 | 1 | 59 | 4 | 75 | 70 | 107 |
| GN 212.5-21-M8-32-E | 21 | M 8 | 32 | 13.5 | 8 | 20 | 33.5 | 1 | 59 | 4 | 75 | 70 | 107 |
| GN 212.5-21-M8-40-E | 21 | M 8 | 40 | 13.5 | 8 | 20 | 33.5 | 1 | 59 | 4 | 75 | 70 | 112 |
| GN 212.5-21-M8-50-E | 21 | M 8 | 50 | 13.5 | 8 | 20 | 33.5 | 1 | 59 | 4 | 75 | 70 | 114 |
| GN 212.5-21-M8-63-E | 21 | M 8 | 63 | 13.5 | 8 | 20 | 33.5 | 1 | 59 | 4 | 75 | 70 | 119 |
| GN 212.5-24-M10-20-E | 24 | M 10 | 20 | 16 | 10 | 25 | 40 | 2.5 | 75 | 4.5 | 101 | 96 | 173 |
| GN 212.5-24-M10-25-E | 24 | M 10 | 25 | 16 | 10 | 25 | 40 | 2.5 | 75 | 4.5 | 101 | 96 | 175 |
| GN 212.5-24-M10-32-E | 24 | M 10 | 32 | 16 | 10 | 25 | 40 | 2.5 | 75 | 4.5 | 101 | 96 | 178 |
| GN 212.5-24-M10-40-E | 24 | M 10 | 40 | 16 | 10 | 25 | 40 | 2.5 | 75 | 4.5 | 101 | 96 | 182 |
| GN 212.5-24-M10-50-E | 24 | M 10 | 50 | 16 | 10 | 25 | 40 | 2.5 | 75 | 4.5 | 101 | 96 | 188 |
| GN 212.5-24-M10-63-E | 24 | M 10 | 63 | 16 | 10 | 25 | 40 | 2.5 | 75 | 4.5 | 101 | 96 | 195 |
| GN 212.5-24-M10-80-E | 24 | M 10 | 80 | 16 | 10 | 25 | 40 | 2.5 | 75 | 4.5 | 101 | 96 | 202 |
| GN 212.5-28-M12-25-E | 28 | M 12 | 25 | 19 | 12 | 30 | 48.5 | 4.5 | 89 | 4.5 | 116 | 110 | 295 |
| GN 212.5-28-M12-32-E | 28 | M 12 | 32 | 19 | 12 | 30 | 48.5 | 4.5 | 89 | 4.5 | 116 | 110 | 300 |
| GN 212.5-28-M12-40-E | 28 | M 12 | 40 | 19 | 12 | 30 | 48.5 | 4.5 | 89 | 4.5 | 116 | 110 | 305 |
| GN 212.5-28-M12-50-E | 28 | M 12 | 50 | 19 | 12 | 30 | 48.5 | 4.5 | 89 | 4.5 | 116 | 110 | 310 |
| GN 212.5-28-M12-63-E | 28 | M 12 | 63 | 19 | 12 | 30 | 48.5 | 4.5 | 89 | 4.5 | 116 | 110 | 322 |
| GN 212.5-28-M12-80-E | 28 | M 12 | 80 | 19 | 12 | 30 | 48.5 | 4.5 | 89 | 4.5 | 116 | 110 | 333 |



3
Clamping levers